

Welcome to



Noremarsch JUNIOR SCHOOL

"Building the foundations for lifelong learning"

Headteacher: Mr A. Simpson
Noremarsch Junior School,
Clarendon Drive,
Royal Wootton Bassett,
Wiltshire, SN4 8BT
admin@noremarsch.wilts.sch.uk
01793 852250

We are really looking forward to welcoming your child to Y3.

This PowerPoint contains video clips that have been produced by our current Year 6 pupils to help you and your child get to know Noremarsch school, routines and key staff.

Please enable sound for this PowerPoint.



Proud to be part of the RWBA Trust

Who we are



Mrs MacMeekin
Head Teacher



Mrs Card
Assistant Head
& Year 6 teacher



Mrs Ballinger
Assistant Head
& SENCo.

Who we are



Mrs Beard



Mrs Kinnet

We work in the school office/reception.

Who we are



Mrs Muttock
Year 3 teacher



Mr Underwood
Year 3 teacher



Miss Titterington
Year 3 teacher

Day in the life of a Year 3 child

8.40	School gates open
8.45	Into class, registration and early morning activity
9.00	Lessons start
10.15	Playtime – milk and toast
10.30	Lessons resume
11.45	Lunch
12.30	Afternoon lessons start
2.45	School finishes



Click on
the
picture
for
video

Uniform



Tops with our logo
can be ordered from
www.myclothing.com



Please
label all
clothing
with your
child's
name.



PE kit

- ▶ PE kits should be **worn** to school on the days that your child has PE.
- ▶ Navy jumpers and jogging bottoms can be worn in colder weather.



Finding your way around

- ▶ Some of our pupils would like to show you around our school.



Click on picture to view video

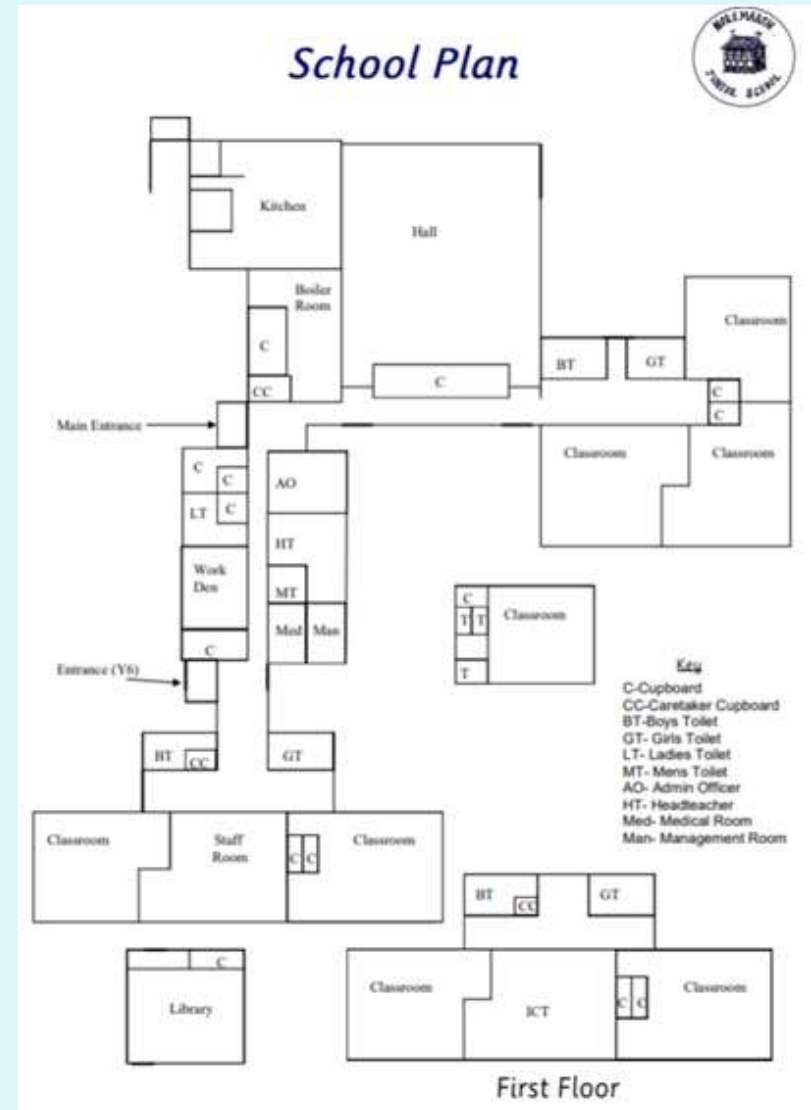

Homework, spelling, reading...

- ▶ Reading card: record all reading, children can write in it. We appreciate parents signing to confirm that children are reading at home.
- ▶ Spelling: Set weekly. A mix of words that children are working on in school, words from the tricky word list and words that they are spelling incorrectly in independent writing.
- ▶ Homework: some weeks the children will be given a task relating to their topic, or maths, spelling and reading.

Special Educational Needs/Disabilities (SEND)

- ▶ At Noremarsh we ensure that all children achieve to the best of their ability, however, sometimes children need a little bit of help with their learning.
- ▶ Your child may have been highlighted at Wootton Bassett Infants as having Special Educational Needs (SEN), and if this is the case, our SEN Co-ordinator, Mrs Ballinger, will have already liaised with the teachers and support staff at the infants to understand their needs and current support – and is busy planning provision and support for them when they arrive at Noremarsh.
- ▶ **For more information on SEND at Noremarsh, please click on the link below:**
 - ▶ [SEND Parents' Leaflet](#)
 - ▶ Or contact Mrs Ballinger at senco@Noremarsh.wilts.sch.uk



Click on picture for video

How are learners supported at Noremmarsh?

- ▶ TA in each class
- ▶ Specific and targeted interventions to boost or 'catch-up' learning
- ▶ Alternative methods of recording, including use of ICT such as speech-to-text.
- ▶ Use of 'concrete' materials in maths
- ▶ Targeted work on specific skills (as set out on their individual plans of support)
- ▶ Access to ICT or specialist equipment
- ▶ Access to our Emotional Literacy Support Assistant (ELSA)
- ▶ Referral and advice from Specialist SEN Service (SSENS), Speech and Language Therapy and Educational Psychologist, or other relevant outside agencies.

This is just some of the ways in which we support our SEND learners.
For more information please see:

[SEND Information Report on our website](#)



Keeping your child safe

- ▶ Ensuring that all our children are safe and well is something that we take very seriously at Noremarsch Junior School.
- ▶ All staff at Noremarsch Junior School have been DBS checked, as have regular professional visitors to the school. As part of our responsibility to keep children safe, staff are regularly trained in safeguarding and to recognise the signs of pupils who need further attention to be kept from harm.
- ▶ Should you have any concerns about our children, please contact either Mrs Ballinger, our Designated Safeguarding Lead (DSL) or Mrs Thorp, our Deputy Designated Safeguarding Lead (DDSL)

Our Safeguarding Team

		
<div style="border: 1px solid black; padding: 5px; width: fit-content; margin: auto;">Mrs J Ballinger Designated Safeguarding Lead</div>	<div style="border: 1px solid black; padding: 5px; width: fit-content; margin: auto;">Mrs K Thorp Deputy Designated Safeguarding Lead</div>	<div style="border: 1px solid black; padding: 5px; width: fit-content; margin: auto;">Mrs K Beard Governor responsible for safeguarding</div>

Our full policies for safeguarding, behaviour, attendance, whistle blowing, anti-bullying, looked after children and many others are available on our school website or on request.

Text messages



- ▶ We use 'Teachers2Parents', the same system used by Wootton Bassett Infants.
- ▶ Newsletters are sent out via a link in a text.
- ▶ Text messages are also used to inform you of other events and changes, e.g. if a club needs to be cancelled, etc.

ParentPay



- ▶ ParentPay is used for all payments to school, for example, school trips and uniform.
- ▶ We prefer payments to school to be made using ParentPay where possible, however we are still able to accept cheques and cash.

Newsletters

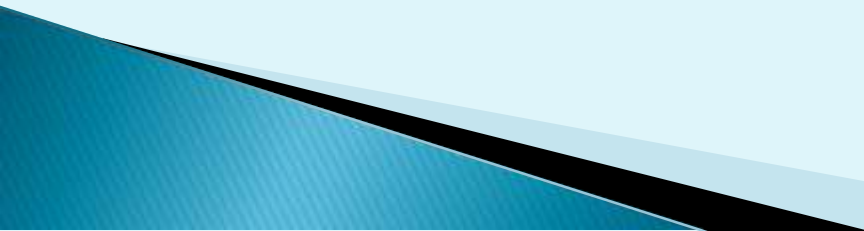
- ▶ Parents are sent a text link to the newsletter which is placed on the school website.
 - ▶ Newsletters contain details of class trips, class achievements, up and coming events, sports news, etc.
 - ▶ Old newsletters are still on the website should you wish to look.
- 

Absence

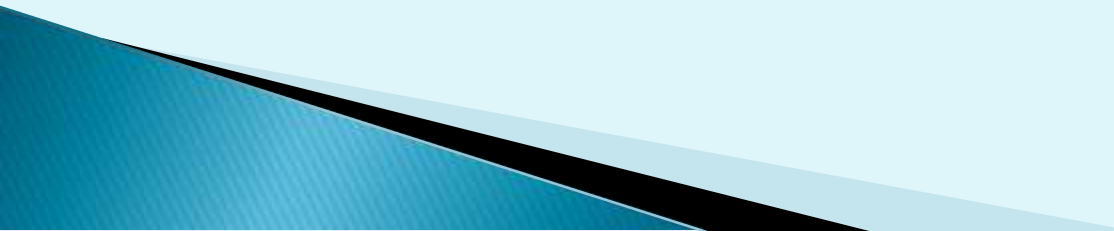
- ▶ If your child is absent from school due to unexpected illness please let us know as soon as possible.
 - ▶ If your child is not in school and we have not heard in advance, then we will contact you to ascertain their whereabouts in order to maintain their safety.
- 

Leave of Absence

- ▶ We do not accept leave of absence requests during term time unless there is an exceptional reason for doing so.
- ▶ If you know that your child will be absent from school, i.e. for a medical appointment or another unavoidable reason, please inform us before their absence by completing a 'Leave of Absence' form. These are available in the foyer of school or by contacting the office.

Health

- ▶ Parents are notified when health checks and immunisations, such as flu, are taking place. Virgin Care will send us details of how parents can opt in and out of these prior to them being administered.

Changes to Contact Details

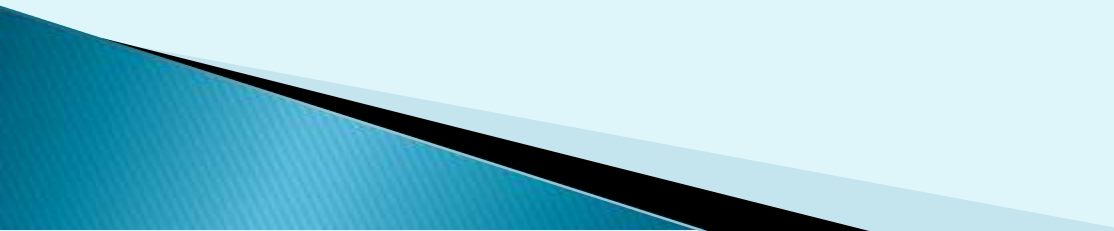
- ▶ Our communication with you relies on you keeping us up to date with changes to your phone numbers, email and home addresses.
 - ▶ Please ensure that school is informed of any changes.
- 

Keeping us up to date

- ▶ As well as keeping school up to date with changes in contact details, it is also helpful to know about any changes that may potentially affect your child in school.
- ▶ Children can be affected quite significantly by some incidents, such as the goldfish being ill, and knowing can help us to support them.

Snacks



- ▶ At break time children are encouraged to eat a healthy, litter-free snack. We are a 'nut free' school.
- ▶ Children need their own water bottle into school each day. These can be refilled throughout the day, but need to be taken home daily for washing.

Lunchtimes



- ▶ Children can either have a school lunch provided by Dolce (the same company used by Wootton Bassett Infant School) or a packed lunch.
- ▶ Dinners are ordered via Dolce's website.
- ▶ At Key Stage 2, dinners are no longer free. If you feel your child qualifies for free school meals then please contact the school office.
- ▶ Packed lunches need to be nut free. We encourage the children to eat a healthy lunch. Water is provided as a drink and fizzy drinks are not allowed.

From a parent's view



[Click here for video](#)

Any questions?

- ▶ Should you have any questions, please do not hesitate to contact us on:
- ▶ kbeard@rwbatrust.org.uk
- ▶ hmacmeekin@noremarsh.wilts.sch



We are looking forward to meeting
you.

